

THE TAMESIDE METROPOLITAN BOROUGH (FIELDS FARM ROAD, HYDE)
(PROHIBITION OF WAITING) ORDER 2024

Please note that all representations sent in response to this Notice are public documents and may be viewed by anyone. Tameside Metropolitan Borough Council proposes to make the above Order under the Road Traffic Regulation Act 1984 the effects of which will be to introduce No Waiting at Any Time restrictions on: -

(1) Bankside (both sides) from its junction with Fields Farm Road for a distance of 10 metres in a south-easterly direction; (2) Callington Drive (both sides) from its junction with Fields Farm Road for a distance of 10 metres in a northerly direction; (3) Fields Farm Close (both sides) from its junction with Fields Farm Road for a distance of 10 metres in a southerly direction; (4) Fields Farm Road (both sides) from its junction with Hattersley Road West for a distance of 15 metres in a north-easterly direction; (5) Fields Farm Road (north side) from a point 10 metres west of its junction with Waterside Walk to a point 10 metres east of that junction; (6) Fields Farm Road (south side) from a point 10 metres west of its junction with Bankside to a point 10 metres east of that junction; (7) Fields Farm Road (north side) from a point 10 metres west of its junction with Waterside Close to a point 10 metres east of that junction; (8) Fields Farm Road (south side) from a point 10 metres west of its junction with Waterside to a point 10 metres east of that junction; (9) Fields Farm Road (north side) from a point 10 metres west of its junction with unnamed access road (between numbers 35 and 37) to a point 11 metres east of that junction; (10) Fields Farm Road (south side) from a point 10 metres west of its junction with Fields Farm Close to a point 10 metres east of that junction; (11) Fields Farm Road (north side) from a point 10 metres west of its junction with Sergeant Mark Stansfield Way to a point 10 metres east of that junction; (12) Fields Farm Road (south side) from a point 10 metres west of its junction with the car park access road (fronting number 94) to a point 10 metres east of that junction; (13) Fields Farm Road (north side) from a point 21 metres west of its junction with Torrington Drive to a point 10 metres east of that junction; (14) Fields Farm Road (south side) from a point 10 metres west of its junction with Tavistock Close to a point 10 metres east of that junction; (15) Fields Farm Road (north side) from a point 10 metres west of its junction with Callington Drive to a point 10 metres east of that junction; (16) Fields Farm Road (both sides) from its junction with Hattersley Road East for a distance of 15 metres in a westerly direction; (17) Hattersley Road East (west side) from a point 15 metres north of its junction with Fields Farm Road to a point 15 metres south of that junction; (18) Hattersley Road West (east side) from a point 65 metres north-west of its junction with Fields Farm Road to a point 15 metres south-east of that junction; (19) Sergeant Mark Stansfield Way (both sides) from its junction with Fields Farm Road for a distance of 10 metres in a north-westerly direction; (20) Tavistock Close (both sides) from its junction with Fields Farm Road for a distance of 10 metres in a southerly direction; (21) Torrington Drive (both sides) from its junction with Fields Farm Road for a distance of 10 metres in a northerly direction; (22) Waterside (both sides) from its junction with Fields Farm Road for a distance of 10 metres in a southerly direction; (23) Waterside Close (both sides) from its junction with Fields Farm Road for a distance of 10 metres in a northerly direction; (24) Waterside Walk (west side) from its junction with Fields Farm Road for a distance of 17 metres in a north-westerly direction; (25) Waterside Walk (east side) from its junction with Fields Farm Road for a distance of 10 metres in a north-westerly direction.

A copy of the proposed Order, plan and statement of reasons relating thereto may be inspected online via <http://www.tameside.gov.uk/trafficregulationorders> or be sent to you at your request by e-mailing highwayenquiries@tameside.gov.uk and asking for the Fields Farm

Road, Hyde deposited documents. Objections or comments to the proposals stating the grounds on which they are being made must be submitted in writing to the undersigned or by email to highwayenquiries@tameside.gov.uk, full name and postal address must be included. The statutory consultation period is a legal minimum of 21 days, however this consultation will extend until 17 July 2025. If you wish to discuss the proposals please contact Ian Hall on 0161 342 3988.

Date: 19 June 2025

E Varnam; Assistant Director of Operations and Neighbourhoods; PO Box 317, Market Place, Ashton-under-Lyne, OL6 6BH

**STATEMENT OF REASONS
THE TAMESIDE METROPOLITAN BOROUGH
(FIELDS FARM ROAD, HYDE)
(PROHIBITION OF WAITING) ORDER 2024**

To improve visibility for pedestrian and vehicular traffic, at the various junctions along Fields Farm Road, Hyde, to avoid congestion and to enhance the general safety. Thereby reducing accident potential and allowing ease of movement for pedestrians and vehicles.



	<p align="center">FIELDS FARM ROAD, HYDE NO WAITING AT ANY TIME RESTRICTIONS</p> <p>KEY</p> <p>— Proposed 'No Waiting at Any Time' restrictions</p>	SCALE	NTS
		DATE	22/08/2024
		DRAWING No.	
		DRAWN BY	MH
		+ Crown copyright. All rights reserved Licence No. 2003	

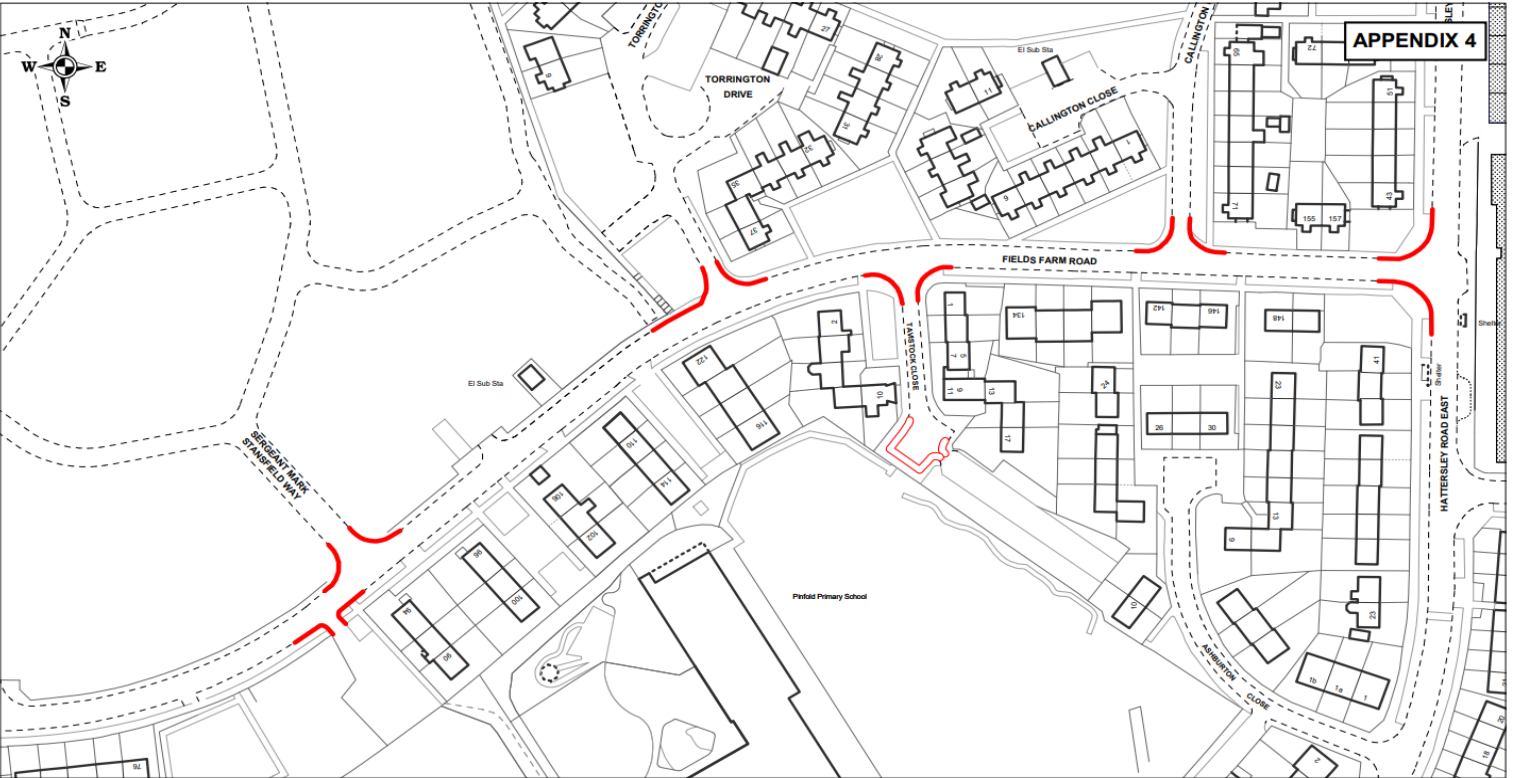

	<p align="center">FIELDS FARM ROAD, HYDE NO WAITING AT ANY TIME RESTRICTIONS</p> <p>KEY</p> <p>— Proposed 'No Waiting at Any Time' restrictions</p> <p>— Existing 'School Entrance Prohibition of Stopping' restrictions</p>	SCALE	NTS
		DATE	22/08/2024
		DRAWING No.	
		DRAWN BY	MH
		+ Crown copyright. All rights reserved Licence No. 2003	

TAMESIDE METROPOLITAN BOROUGH COUNCIL

**THE TAMESIDE METROPOLITAN BOROUGH
(FIELDS FARM ROAD, HYDE)
(PROHIBITION OF WAITING) ORDER 2024**

The Tameside Metropolitan Borough Council in exercise of its powers under Sections 1(1), 2(1) and 2(2) of the Road Traffic Regulation Act 1984 (“the Act”) and Part IV of Schedule 9 and all other enabling powers and after consultation with the Chief Officer of Police in accordance with Part III of Schedule 9 to the Act hereby makes the following Order:-

1. (1) In this Order:-

“disabled person’s badge” has the same meaning as in the Disabled Persons (Badges For Motor Vehicles)(England) Regulations 2000;

“disabled person’s vehicle” means a vehicle which displays a disabled person’s badge in accordance with the provisions of the Disabled Persons (Badges for Motor Vehicles) (England) Regulations 2000 as amended, or under any succeeding legislation, and shall include a badge issued under regulations having effect in Scotland or Wales under Section 21 of the Chronically Sick and Disabled Person’s Act 1970, and a recognised badge under Section 21A and B of the 1970 Act;

“parking disc” means a disc issued by a local authority, 125 millimetres square, coloured blue and capable of showing the quarter hour period during which a period of waiting begins.

(2) For the purpose of this Order a vehicle shall be regarded as displaying:-

(a) a disabled person’s badge in the relevant position, when:-

- (i) the badge is exhibited on the dashboard or fascia of the vehicle so that the front of the badge is clearly legible from the outside of the vehicle or;
- (ii) where a vehicle is not fitted with a dashboard or fascia, the badge is exhibited in a conspicuous position on the vehicle, so that the front of the badge is clearly legible from the outside of the vehicle.

(b) a parking disc in the relevant position if;

- (i) the disc is exhibited on the dashboard or fascia of the vehicle and shows the quarter hour period during which a period of waiting began and that period is clearly legible from the outside of the vehicle or;
- (ii) where the vehicle does not have a dashboard or fascia, the disc is exhibited in a conspicuous position on the vehicle, so that, when marked to show the quarter hour period during which a period of waiting began and that period is clearly legible from the outside of the vehicle.

- (3) except where otherwise stated, any reference in this Order to a numbered Article or Schedule is a reference to the Article or Schedule bearing that number in this Order.
2. Save as provided in Article 3 to this Order no person shall except upon the direction or with the permission of a police constable in uniform or of a civil enforcement officer, cause or permit any vehicle to wait at any time on the sides of lengths of roads specified in the Schedule to this Order.
3. (1) Nothing in Article 2 shall render it unlawful to cause or permit any vehicle to wait on the sides of lengths of roads referred to therein for so long as may be necessary to enable:-
- (a) persons to board or alight from a vehicle;
 - (b) the vehicle, if it cannot conveniently be used for such purpose in any other road, to be used in connection with any of the following operations, namely:-
 - (i) building, industrial or demolition operations;
 - (ii) the removal of any obstruction to traffic;
 - (iii) the maintenance, improvement or reconstruction of the said sides of lengths of roads; or
 - (iv) the laying, erection, alteration or repair in, or the land adjacent to, the sides of lengths of roads of any sewer or of any main, pipe or apparatus for the supply of gas, water or electricity or any electronic communications network as defined in the Communications Act 2003.
 - (c) the vehicle, if it cannot conveniently be used for such purpose in any other road, to be used in the service of a local authority or any other Authority in the pursuance of statutory powers or duties;
 - (d) the vehicle, to be used for the purpose of delivering or collecting postal packets as defined in the Postal Services Act 2000;
 - (e) the vehicle to wait at or near to any premises situated on or adjacent to the sides of lengths of roads for so long as such waiting is reasonably necessary in connection with any wedding or funeral; or
 - (f) the vehicle to be used for Fire Brigade, Ambulance or Police purposes.
- (2) Nothing in Article 2 to this Order shall render it unlawful to cause or permit any vehicle to wait for so long as may be necessary for the purpose of enabling goods to be loaded onto or unloaded from the vehicle on the sides of lengths of roads specified in the Schedule to this Order, at any time.
- (3) Nothing in Article 2 to this Order shall render it unlawful to cause or permit a disabled person's vehicle which displays in the relevant position a disabled

person's badge and a parking disc (on which the driver, or person in charge of the vehicle, has marked the time at which the period of waiting began) to wait on any of the sides of lengths of roads referred to in the Schedule to this Order for a period not exceeding three hours (not being a period separated by an interval of less than one hour from a previous period of waiting by the same vehicle on the same side of length of road on the same day)

4. The prohibitions and restrictions imposed by this Order shall be in addition to and not in derogation from any restrictions or requirement imposed by any regulations made or having effect as if made under the said Act of 1984 or by or under any other enactment.

The Order shall come into operation on the <date> day of <month and year> and may be cited as "THE TAMESIDE METROPOLITAN BOROUGH (FIELDS FARM ROAD, HYDE) (PROHIBITION OF WAITING) ORDER 2024"

**THE COMMON SEAL OF TAMESIDE
METROPOLITAN BOROUGH COUNCIL**

was hereunto affixed on the <date> day of
<month and year> in the presence of

Authorised Signatory

<u>SCHEDULE</u>		
No Waiting at Any Time		
Bankside (both sides)	-	from its junction with Fields Farm Road for a distance of 10 metres in a south-easterly direction.
Callington Drive (both sides)	-	from its junction with Fields Farm Road for a distance of 10 metres in a northerly direction.
Fields Farm Close (both sides)	-	from its junction with Fields Farm Road for a distance of 10 metres in a southerly direction.
Fields Farm Road (both sides)	-	from its junction with Hattersley Road West for a distance of 15 metres in a north-easterly direction.
Fields Farm Road (north side)	-	from a point 10 metres west of its junction with Waterside Walk to a point 10 metres east of that junction.

Fields Farm Road (south side)	-	from a point 10 metres west of its junction with Bankside to a point 10 metres east of that junction.
Fields Farm Road (north side)	-	from a point 10 metres west of its junction with Waterside Close to a point 10 metres east of that junction.
Fields Farm Road (south side)	-	from a point 10 metres west of its junction with Waterside to a point 10 metres east of that junction.
Fields Farm Road (north side)	-	from a point 10 metres west of its junction with unnamed access road (between numbers 35 and 37) to a point 11 metres east of that junction.
Fields Farm Road (south side)	-	from a point 10 metres west of its junction with Fields Farm Close to a point 10 metres east of that junction.
Fields Farm Road (north side)	-	from a point 10 metres west of its junction with Sergeant Mark Stansfield Way to a point 10 metres east of that junction.
Fields Farm Road (south side)	-	from a point 10 metres west of its junction with the car park access road (fronting number 94) to a point 10 metres east of that junction.
Fields Farm Road (north side)	-	from a point 21 metres west of its junction with Torrington Drive to a point 10 metres east of that junction.
Fields Farm Road (south side)	-	from a point 10 metres west of its junction with Tavistock Close to a point 10 metres east of that junction.
Fields Farm Road (north side)	-	from a point 10 metres west of its junction with Callington Drive to a point 10 metres east of that junction.
Fields Farm Road (both sides)	-	from its junction with Hattersley Road East for a distance of 15 metres in a westerly direction.
Hattersley Road East (west side)	-	from a point 15 metres north of its junction with Fields Farm Road to a point 15 metres south of that junction.
Hattersley Road West (east side)	-	from a point 65 metres north-west of its junction with Fields Farm Road to a point 15 metres south-east of that junction.
Sergeant Mark Stansfield Way (both sides)	-	from its junction with Fields Farm Road for a distance of 10 metres in a north-westerly direction.
Tavistock Close (both sides)	-	from its junction with Fields Farm Road for a distance of 10 metres in a southerly direction.
Torrington Drive (both sides)	-	from its junction with Fields Farm Road for a distance of 10 metres in a northerly direction.