

**TAMESIDE METROPOLITAN BOROUGH (MONTAGUE ROAD, ASHTON-UNDER-LYNE)  
(PROHIBITION OF DRIVING) ORDER 2025**

Tameside Metropolitan Borough Council in exercise of its powers under Road Traffic Regulation Act 1984 proposes to make the above Order, the effect of which will be to introduce: - A Prohibition of Driving Order on Montague Road, Ashton-under-Lyne.

No person shall cause or permit any vehicle except for pedal cycles to enter or leave Montague Road, Ashton-under-Lyne, from its southerly junction with Beaufort Road, Ashton-under-Lyne.

**TAMESIDE METROPOLITAN BOROUGH COUNCIL HIGHWAYS ACT 1980**

Traffic Calming Features, Beaufort Road, Ashton-under-Lyne. In accordance with the Highways Act 1980 it is proposed to implement a series of traffic calming features (Road Humps and Speed Cushions) along Beaufort Road, Ashton-under-Lyne: -

**Speed Cushion**

(Width Approx 1.7m; height 75mm; 3.7m long)

<u>Road</u>	<u>Ref.no</u>	<u>Location</u>
Beaufort Road	SC-01	Set of three speed cushions centred about a point approximately 158 metres southeast of its junction with Derby Road

**Road Hump**

(Length of top 6m; height 75mm; ramp gradient 1 in 15)

<u>Road</u>	<u>Ref.no</u>	<u>Location</u>
Beaufort Road	RH-01	Centred about a point approximately 53 metres southeast of its junction with Mossley Road
	RH-02	Centred about a point approximately 53 metres northwest of its junction with Derby Road
	RH-03	Centred about a point approximately 48 metres southeast of its junction with Derby Road
	RH-04	Centred about a point approximately 38 metres southeast of its junction with Dorset Street
	RH-05	Centred about a point approximately 34 metres northwest of its junction with Hutton Avenue

The speed hump and cushions will be constructed to comply with the Highways (Road Humps) Regulations 1996 and will be signed in accordance with the said Regulations and The Traffic Signs Regulations and General Directions 2016.

A plan showing the locations of the humps may be inspected online via <http://www.tameside.gov.uk/trafficregulationorders> or be sent to you at your request by e-mailing [highwayenquiries@tameside.gov.uk](mailto:highwayenquiries@tameside.gov.uk) asking for Beaufort Road, Ashton-under-Lyne scheme deposited documents. Statements of support, objections or comments to the proposals stating the grounds on which they are being made must be submitted in writing to the undersigned or by e-mail to [highwayenquiries@tameside.gov.uk](mailto:highwayenquiries@tameside.gov.uk) by no later than 30 October 2025, full name and postal address must be included. Objections may be published. If you wish to discuss the proposal please contact Traffic Operations on 0161 342 3988 or 0161 342 2964

Date: 02 October 2025

E Varnam; Assistant Director of Environment, Housing and Estates; PO Box 317, Market Place, Ashton-under-Lyne, OL6 6BH

## **Statement of Reasons**

Greater Manchester Combined Authority (GMCA) announced the Integrated Transport Block (ITB), a funding stream to be divided between the 10 Highway Authorities of Greater Manchester and Transport for Greater Manchester (TfGM) over a five-year period from 2022/2023.

On the 22 November 2023 the council's Executive Cabinet approved a report which set out the council's proposed approach to allocate the ITB funding to deliver a range of prioritised highway safety infrastructure schemes. On the 30 October 2024 Executive Cabinet approval was obtained to design and develop the 10 highest ranked schemes on a prioritised Highway Safety programme.

Beaufort Road, Stalybridge is ranked number 10 in the prioritised programme.

To address the traffic related issues and mitigate the identified conflict points it is proposed to:

- Introduce a combination of flat top road humps and speed cushions along the full length of Beaufort Road to support compliance with the 30mph speed limit. The introduction of traffic calming features will encourage lower vehicle speeds and driver compliance with the 30mph speed limit along Beaufort Road.
- Stop up Montague Road to motorised traffic at its southerly junction with Beaufort Road, by means of new kerblines and bollards, while still maintaining access for pedestrians and cyclists. The closure of Montague Road (except for cycles) will remove a key conflict point at a busy crossroads, thereby reducing the potential for collisions.
- Widen the carriageway on Beaufort Road to accommodate a new lane configuration, while still maintaining a two-metre-wide footway on the south side of Beaufort Road. Early lane designation indicated by road markings, helps drivers to choose the correct lane in advance of a junction. Clear lane guidance reduces the risk of accidents caused by late lane changes.

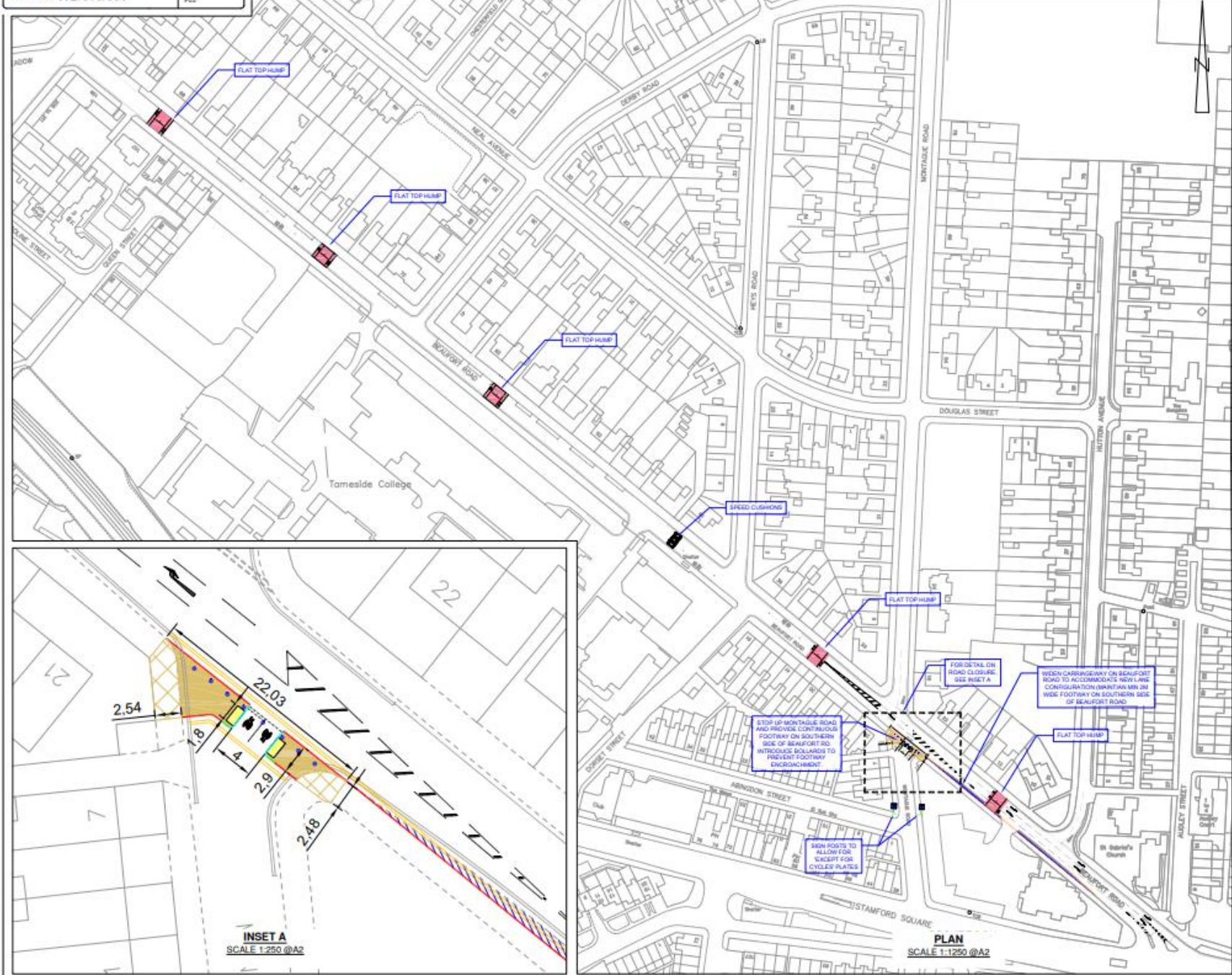

- KEY:**
- PROPOSED SPEED CUSHIONS
  - PROPOSED ROAD HUMP
  - PROPOSED SIGNS
  - PROPOSED ROAD MARKINGS
  - PROPOSED KERB
  - PROPOSED TRANSITION
  - PROPOSED BULLNOSE KERB
  - PROPOSED NEW FOOTWAY CONSTRUCTION
  - PROPOSED FOOTWAY RESURFACING
  - PROPOSED CARRIAGEWAY WIDENING
  - PROPOSED BOLLARDS
  - EXISTING SIGNS
  - EXISTING ROAD MARKINGS
  - PROPOSED/AMENDED TRD
  - EXISTING TRD

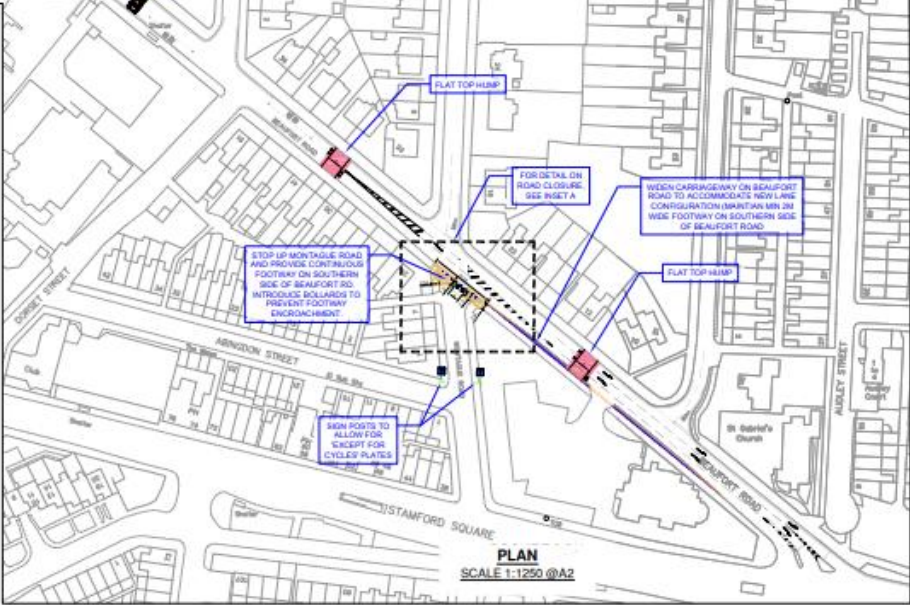

PRD	21.06.22	Sub-alignment updated	NU
DRN	25.09.22	Final Issue	CP
REV	02.09.23	Details	TRB

**Tameside Metropolitan Borough**

**ENVIRONMENT**  
Assistant Director: Emma Vansan  
Head of Engineering Services: Lee Holland  
Tame Street Depot, Tame Street, Stalybridge, SK15 1ST.  
Email: highwayengineering@tameside.gov.uk  
Tel: 0161 342 5355 www.tameside.gov.uk

Title  
**ITB FUNDING SCHEMES**  
**10 - BEAUFORT ROAD, ASHTON**

Scale	Drawn	Checked	Scheme ID
AS SHOWN	GPL	CP	ITB010
	Date	Date	Drawing Status
	20.08.2025		PRELIMINARY

**TAMESIDE METROPOLITAN BOROUGH COUNCIL**

**TAMESIDE METROPOLITAN BOROUGH**  
**(MONTAGUE ROAD, ASHTON-UNDER-LYNE)**  
**(PROHIBITION OF DRIVING) ORDER 2025**

THE TAMESIDE METROPOLITAN BOROUGH COUNCIL in exercise of its powers under Sections 1(1), 2(1), 2(2) and 4(2) of the Road Traffic Regulation Act 1984 (“the Act”) and of all other enabling powers and after consultation with the Chief Officer of Police in accordance with Part III of Schedule 9 to the Act hereby makes the following Order:-

1. “pedal cycle” has the same meaning as in Schedule 1 of the Traffic Signs Regulations and General Directions 2016 (or any amendment thereof);
2. No person shall cause or permit any vehicle except for pedal cycles to enter or leave Montague Road, Ashton-under-Lyne, from its southerly junction with Beaufort Road, Ashton-under-Lyne.

The Order shall come into operation on the x day of [month] 2025 and may be cited as “**THE TAMESIDE METROPOLITAN BOROUGH (MONTAGUE ROAD, ASHTON-UNDER-LYNE) (PROHIBITION OF DRIVING) ORDER 2025**”

THE COMMON SEAL OF TAMESIDE  
METROPOLITAN BOROUGH COUNCIL  
was hereunto affixed on the 24 day of  
September 2024 in the presence of

**Director of Legal and Democratic Services (Monitoring Officer)**